

Muttern DIN 6327

Nutmutter DIN 6327

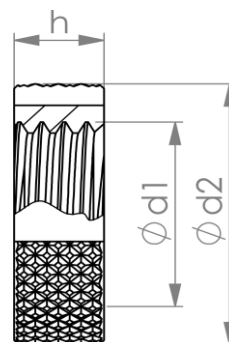

d1	d2	h	Art.-Nr.
Tr 8x1,0	14,8	5	NM08-1
Tr 10x1,5	17,8	6	NM10-1,5
Tr 12x1,5	19,7	6	NM12-1,5

Klemmmutter DIN 6327

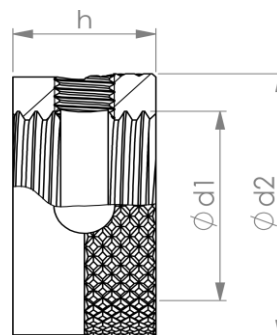

d1	d2	h	Art.-Nr.
Tr 16x1,5	24,6	12	KL16-1,5
Tr 20x2,0	31,6	12	KL20-2
Tr 25x2,0	36,6	12	KL25-2
Tr 28x2,0	39,6	12	KL28-2
Tr 32x2,0	44,6	12	KL32-2
Tr 36x2,0	49,6	14	KL36-2
Tr 48x2,0	66,6	18	KL48-2



ROBERT KOCH GmbH
Präzisionswerkzeuge
Mauersteige 2
D 72469 Tübingen
Tel. 07436-9283-0

Muttern DIN 6327

Klemmmutter DIN 6327, skaliert

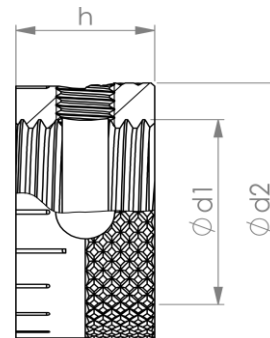

d1	d2	h	Art.-Nr.
Tr 16x1,5	24,6	12	KL16-1,5SK
Tr 20x2,0	31,6	12	KL20-2SK
Tr 25x2,0	36,6	12	KL25-2SK
Tr 28x2,0	39,6	12	KL28-2SK
Tr 32x2,0	44,6	12	KL32-2SK
Tr 36x2,0	49,6	14	KL36-2SK
Tr 48x2,0	66,6	18	KL48-2SK